

## M8 Male to Female Panel Mount

- Connector series: M8
- Gender: Male/female
- Coding: A,B
- Locking type: Fix screw
- Mounting type: Straight
- Part No.: MT-004~006

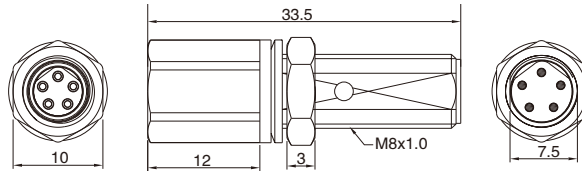

### General information

Standard:	IEC 61076-2-104
Ambient temperature:	-25 °C ~ +90 °C
Connector insert:	TPU / PA+GF
Connector contacts:	Brass with gold plated
Connector nut/screw:	Brass with nickel plated
Seal / O-ring:	Epoxy resin / FKM

Insulation resistance:	≥ 100MΩ
Contact resistance:	≤ 5mΩ
Shielding:	Unavailable
IP rating:	IP67 in locked condition
Panel cut-out:	Refer to page 62
Mating endurance:	>500 cycles

### Electrical data & Mechanical data

	Contacts		Rated current	Voltage		Part No.
				A/C	D/C	
03 pins (A-coding)			3A	50V	60V	MT-004
04 pins (A-coding)			3A	50V	60V	MT-005
05 pins (B-coding)			3A	30V	30V	MT-006